

Excise and Taxation Department,  
Government of Haryana



User Manual

Add Blending Vessel

## EI Login – Blending vessel Creation Process

1. The Excise Inspector (EI) logs into the system using their official credentials.

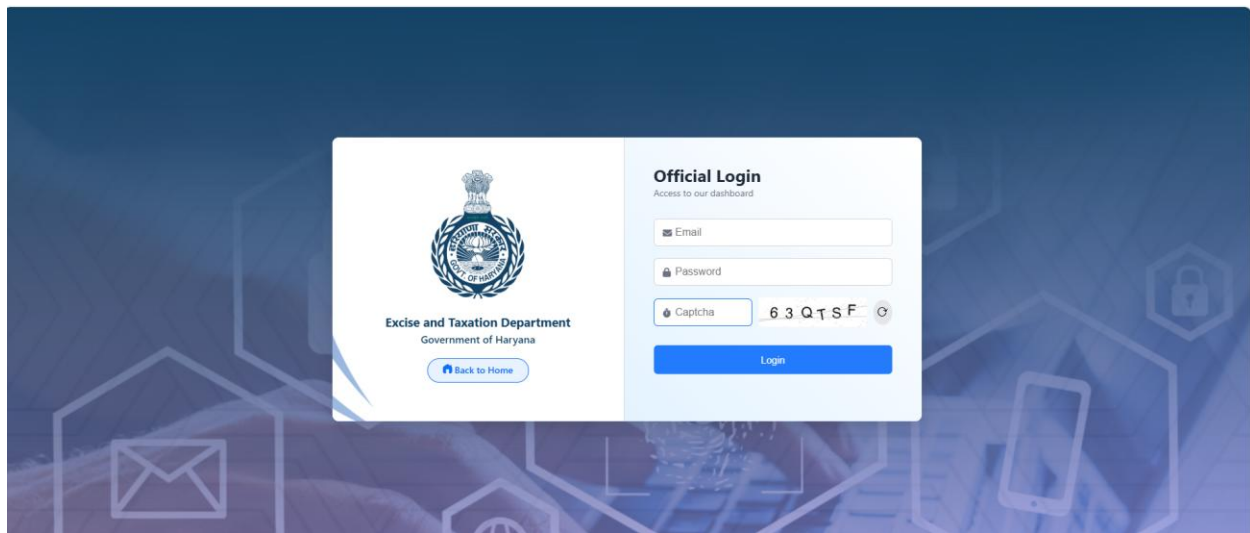
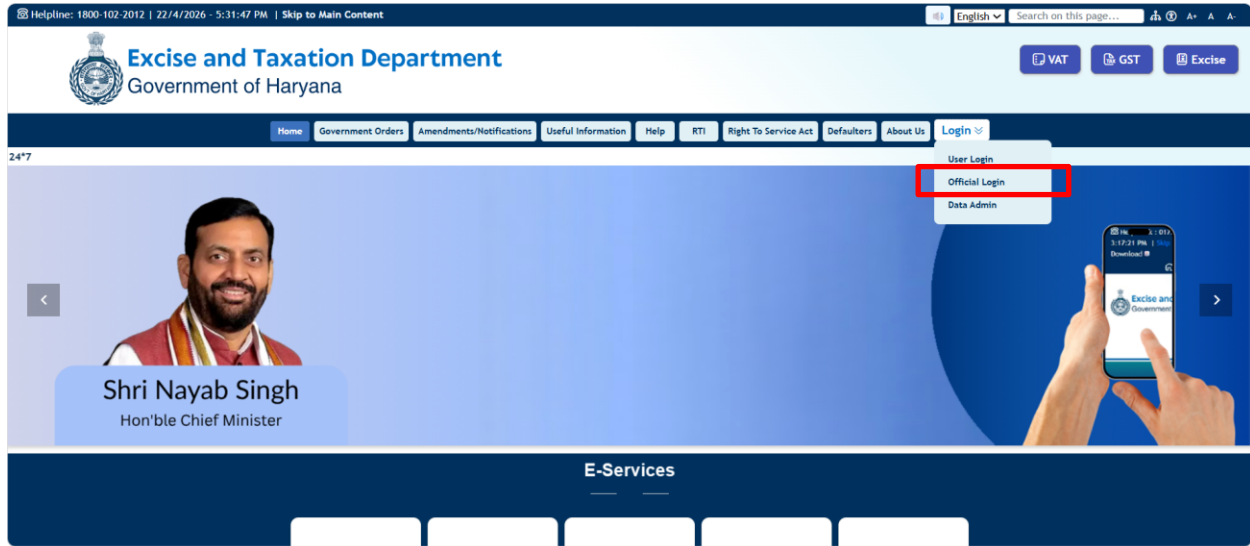

2. From the main menu, navigate to **E-Services** and select **Blending Vessel Master**.

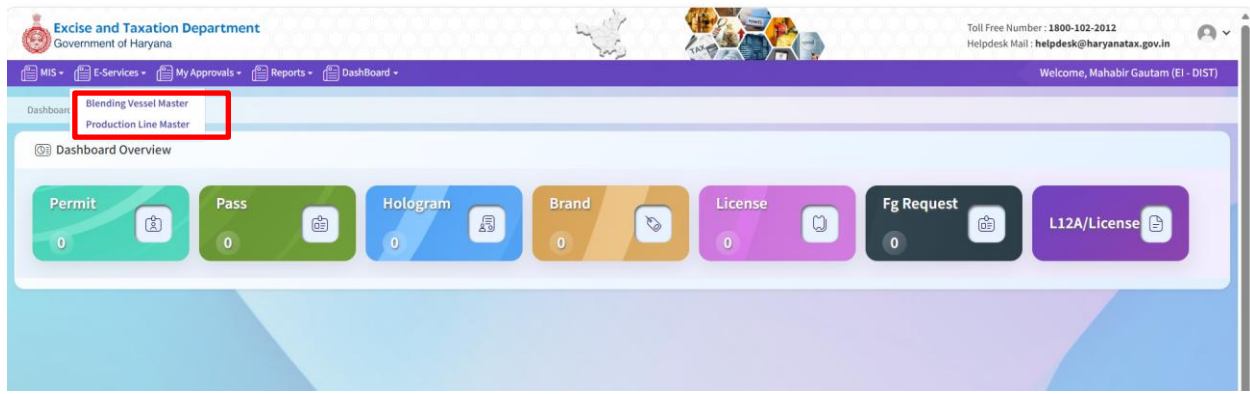

3. Select the required **Licensee** from the dropdown list.

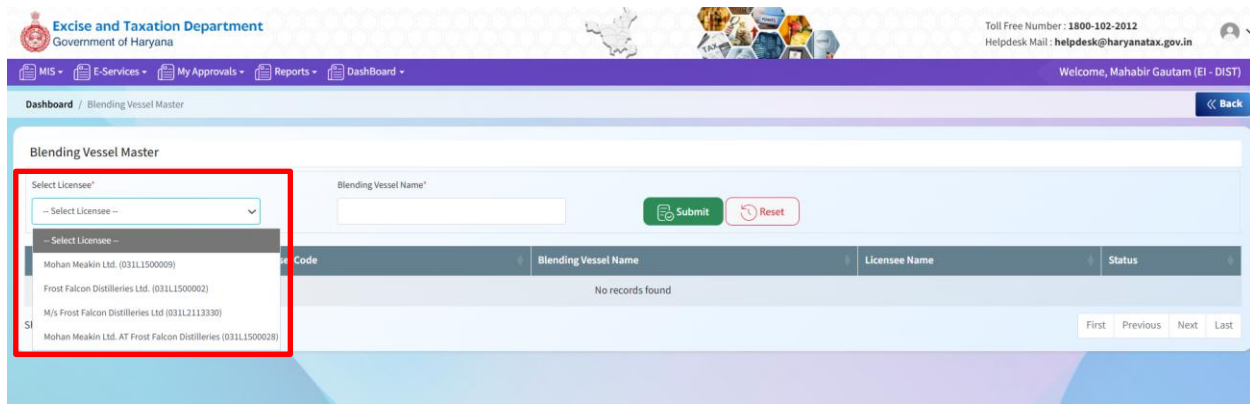

4. Enter the **Blending Vessel Name** in the designated field.

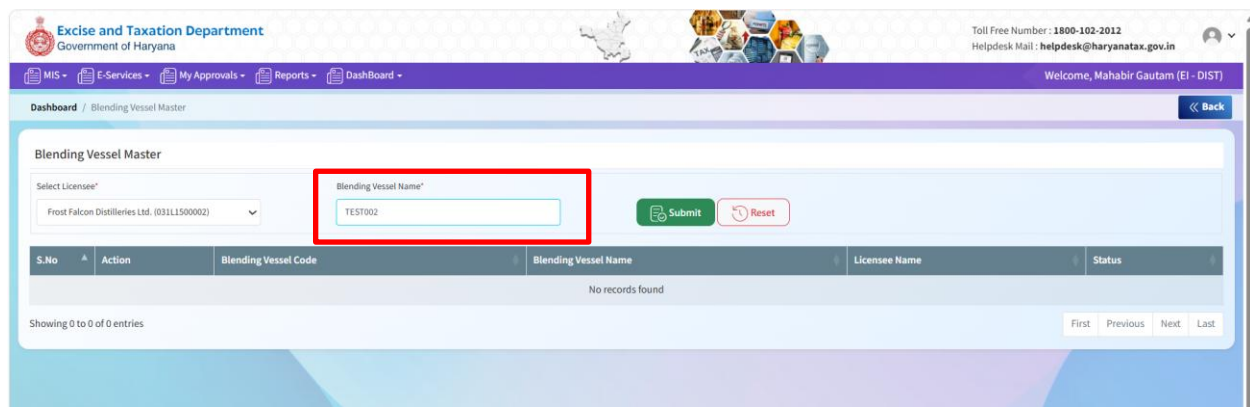

5. Click **Submit** to submit the blending vessel creation request.

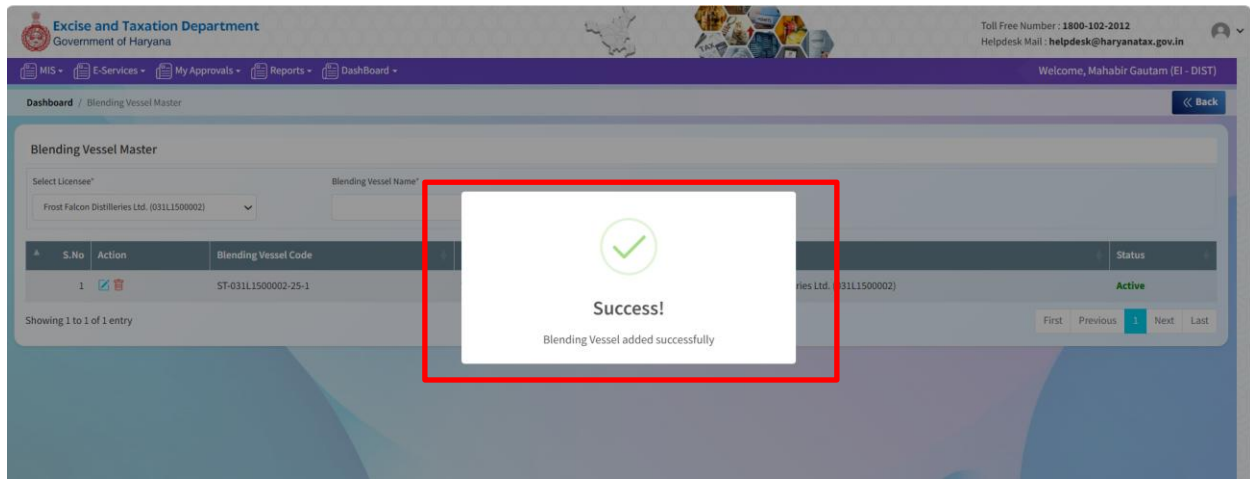

6. Upon successful submission, the system displays a confirmation message and the blending vessel record is created.

